

CORRENTES ESPECIAIS

A-1

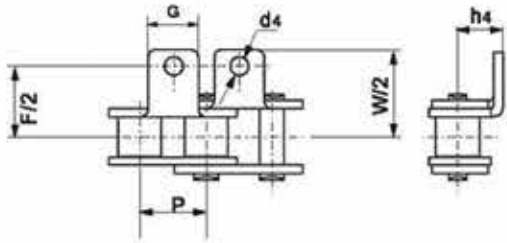

K-1

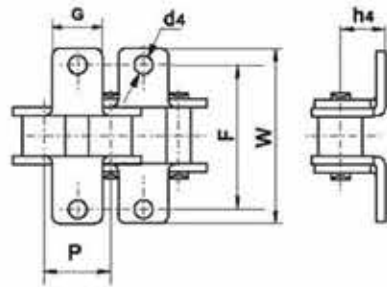

SA-1

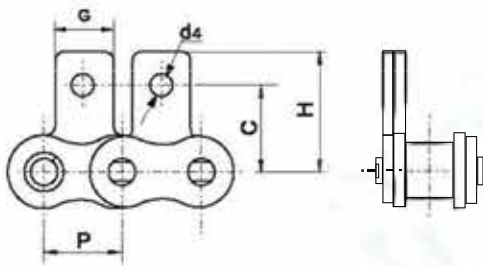

SK-1

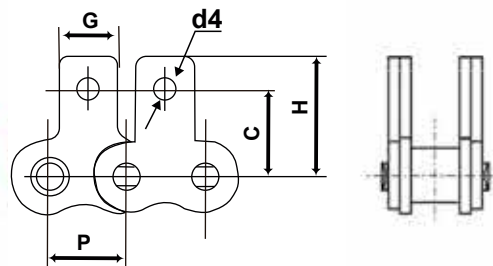

WA-2

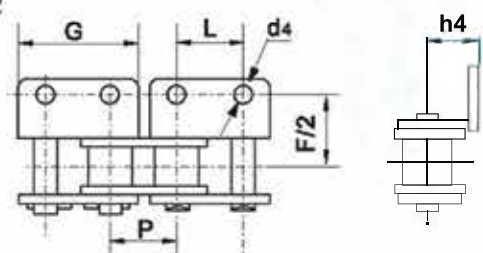

WK-2

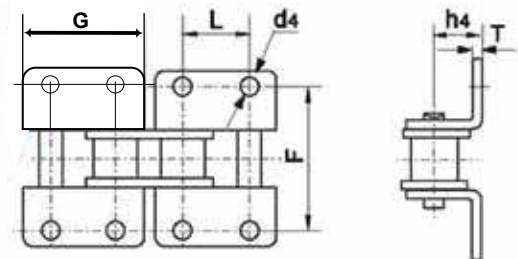

WSK-2

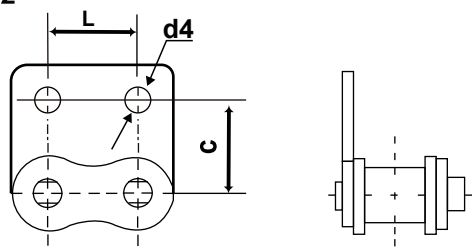

WSK-2

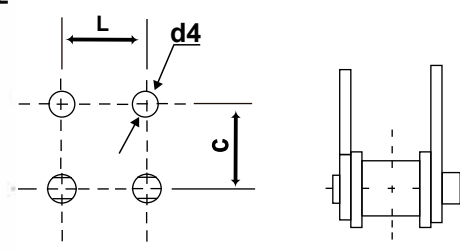

D-1

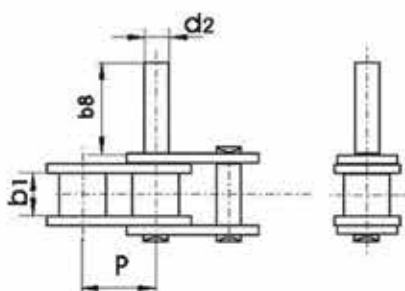

D-3

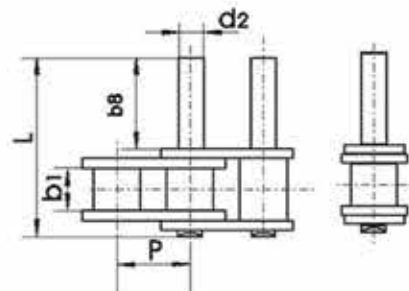



ADICIONAIS PARA CORRENTES ESPECIAIS - ANSI / ISO

Norma DIN/ISO	Norma ANSI	P	Tipo	G	L	C	F	W	T	h4	d4	d2	b8
08A	40	12.7	A1/K1	9.50	-	-	25.4	35.2	1.50	7.9	3.4	3.96	9.5
			SA1/SK1	9.50	-	12.70	19.05	-	1.50	-	3.4		
			WA1/WK1	23.00	-	-	25.40	35.6	1.50	7.9	3.4		
			WA2/WK2	23.00	12.700	-	25.40	35.6	1.50	7.9	3.4		
			WSA1/WSK1	23.00	12.700	12.70	17.40	-	1.50	-	3.4		
			WSA2/WSK2	23.00	12.700	12.70	17.40	-	1.50	-	3.4		
10A	50	15.875	A1/K1	12.70	-	-	31.75	46.2	2.03	10.3	5.5	5.08	11.9
			SA1/SK1	12.70	-	15.90	25.25	-	2.03	-	5.5		
			WA1/WK1	28.80	-	-	31.75	46.8	2.03	10.3	5.5		
			WA2/WK2	28.80	15.875	-	31.75	46.8	2.03	10.3	5.5		
			WSA1/WSK1	28.80	-	15.90	23.05	-	2.03	-	5.5		
			WSA2/WSK2	28.80	15.875	15.90	23.05	-	2.03	-	5.5		
12A	60	19.05	A1/K1	15.90	-	-	38.10	55.6	2.42	11.9	5.5	5.94	14.3
			SA1/SK1	15.90	-	18.30	29.33	-	2.42	-	5.5		
			WA1/WK1	34.65	-	-	38.10	56.4	2.42	11.9	5.5		
			WA2/WK2	34.65	19.050	-	38.10	56.4	2.42	11.9	5.5		
			WSA1/WSK1	34.65	-	18.30	26.86	-	2.42	-	5.5		
			WSA2/WSK2	34.65	19.050	18.30	26.86	-	2.42	-	5.5		
16A	80	25.4	A1/K1	19.10	-	-	50.80	64.8	3.25	15.9	6.8	7.92	19.1
			SA1/SK1	19.10	-	24.60	34.70	-	3.25	-	6.8		
			WA1/WK1	45.90	-	-	50.80	73.2	3.25	15.9	6.8		
			WA2/WK2	45.90	25.400	-	50.80	73.2	3.25	15.9	6.8		
			WSA1/WSK1	45.90	-	24.60	35.45	-	3.25	-	6.8		
			WSA2/WSK2	45.90	25.400	24.60	35.45	-	3.25	-	6.8		
08B		12.7	A1/K1	9.50	-	-	25.40	36.4	1.60	8.9	4.5	4.45	9.5
			SA1/SK1	9.50	-	13.35	18.90	-	1.60	-	4.3		
			WA1/WK1	24.00	-	-	25.40	36.4	1.60	8.9	4.3		
			WA2/WK2	24.00	12.700	-	25.40	36.4	1.60	8.9	4.3		
			WSA1/WSK1	23.30	-	13.35	18.90	-	1.60	-	4.3		
			WSA2/WSK2	23.30	12.700	13.35	18.90	-	1.60	-	4.3		
10B		15.875	A1/K1	14.30	-	-	31.75	44.6	1.70	10.31	5.3	5.08	11.9
			SA1/SK1	14.30	-	16.50	22.95	-	1.70	-	5.3		
			WA1/WK1	29.58	-	-	31.80	44.6	1.70	10.31	5.3		
			WA2/WK2	29.58	15.875	-	31.80	44.6	1.70	10.31	5.3		
			WSA1/WSK1	29.58	-	16.50	22.95	-	1.70	-	5.3		
			WSA2/WSK2	29.58	15.875	16.50	22.95	-	1.70	-	5.3		
12B		19.05	A1/K1	16.00	-	-	38.10	52.4	1.85	13.46	6.4	5.72	14.3
			SA1/SK1	16.00	-	21.45	28.60	-	1.85	-	6.4		
			WA1/WK1	34.05	-	-	38.10	52.4	1.85	13.46	6.4		
			WA2/WK2	34.05	19.050	-	38.10	52.4	1.85	13.46	6.4		
			WSA1/WSK1	34.05	-	21.45	28.60	-	1.85	-	6.4		
			WSA2/WSK2	34.05	19.050	21.45	28.60	-	1.85	-	6.4		
16B		25.4	A1/K1	19.10	-	-	50.80	72.6	3.10	15.88	6.4	8.28	19.1
			SA1/SK1	19.10	-	23.15	34.00	-	3.10	-	6.4		
			WA1/WK1	46.40	-	-	50.80	72.6	3.10	15.88	6.4		
			WA2/WK2	46.40	25.400	-	50.80	72.6	3.10	15.88	6.4		
			WSA1/WSK1	46.40	-	23.15	34.00	-	3.10	-	6.4		
			WSA2/WSK2	46.40	25.400	23.15	34.00	-	3.10	-	6.4		